

# Tramiflex

A waterproofing membrane for external joinery

- Perfect sealant between framework and joinery
- Accommodates differential joint movement
- Water vapour permeability tested
- Easy installation

## Multi-purpose Applications

Tramiflex is an air & waterproofing membrane specifically designed for external peripheral joinery joints.

The combination of Tramiflex Interior and Tramiflex Exterior prevents the appearance of condensation in the joints, caused by the difference in external and interior temperature.

Tramiflex Interior has low condensation permeability (SD: 55m).

Tramiflex Exterior is designed to evacuate a large quantity of water vapour towards the exterior of the building (SD: 0.1m).



Tramiflex Interior



Tramiflex Exterior

Tramiflex Interior guarantees airtightness and compensates joint movement.

Compriband HPE provides intermediate acoustic and thermal insulation.

Tramiflex Exterior guarantees airtightness and compensates joint movement.

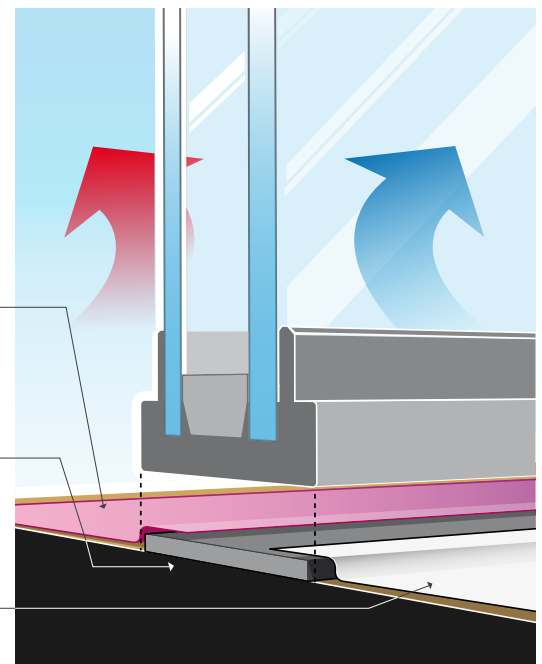



Coulombs  
28210 Nogent-le-Roi  
France

Tel. +33 (0)2 37 38 64 00  
Fax +33 (0)2 37 38 64 01  
div.batiment@tramico.fr

A Vita Group Company



## Product Benefits

- Tramiflex is resistant to air and wind driven rain.
- Water vapour permeability is controlled through the combination of interior and exterior membranes.
- The membrane's suppleness facilitates its' installation which in turn ensures the accommodation of differential joint movement.
- Tramiflex is ideal for sealing low energy buildings, as well as positive energy buildings.
- Equipped with extra-strength adhesive, Tramiflex is not only easy to install but is also long lasting. For joinery elements the adhesive strips adhere easily to PVC, wood and aluminum. In regards to masonry elements, the butyl strip adheres easily to clean and dust-free surfaces.
- Glue can be used to attach the adhesive strip instead of the butyl (variant A).
- Tramiflex variants B & C are deal for all types of installation.
- Tramiflex can be painted or mortar coated.

## Product Characteristics

	Norme	Tramiflex Intérieur	Tramiflex Extérieur
Colour		Red	White
Base	High quality plastic sheet, laminated with a non-woven on each side.		
Tear Strength - Longitudinal	DIN EN 12 311-2	> 650 N/50mm	> 600 N/50mm
Tear Strength - Transversal	-	140 N/50mm	90 N/50mm
Elongation at break - Longitudinal	-	> 35 %	> 35 %
Elongation at break - Transversal	-	> 250 %	> 200 %
Fire resistance	DIN 4102-1	Class B2	-
	EN ISO 11925-2	Class E	-
Airtightness	DIN 4108-7	Airtight	-
Water permeability	DIN EN 1928-B	1 bar/24hr	
SD value	DIN EN ISO 12572	55m	0,1m
UV resistance	DIN1931	3 months	-
Storage guarantee	2 yrs minimum at 5°C – 25°C in packaging		
Temperature threshold	-	-30°C à 80°C	
Usage temperature	-	5°C à 35°C	

## Packing

Available widths: 70, 100 & 150mm

Roll lengths: variant A = 40m, variant B & C = 20m

Packaging: 70mm = 5 rolls per pack, 100mm = 3 rolls per pack, 150mm = 2 rolls per pack